



#### FEATURES

THE SUBSTANTIAL EBONY WOODEN COLUMN HAS DEEP RIBBED GROOVES TO THE LOWER SECTION. GOLDEN BRONZE ACCENTS ADD RICH HIGHLIGHTS TO THIS TIMELESS DESIGN, SUITABLE FOR USE IN BOTH MODERN AND TRADITIONAL INTERIORS.

#### MATERIAL

WOOD AND STEEL

#### FINISH

EBONY WITH GOLDEN BRONZE (EB/GB)

#### RECOMMENDED LAMP

1 X E27 7W LED 2700K

#### CERTIFICATIONS

CE UK CA UL  $\equiv$  IP20

#### DIMENSIONS

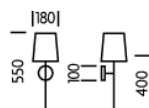

## FULL TECHNICAL SPECIFICATION

MATERIAL	WOOD AND STEEL	INSULATION RATING	CLASS I
FINISH	EBONY WITH GOLDEN BRONZE (EB/GB)	IP RATING	IP20
LAMPHOLDER TYPE	E27	PROJECTION	220MM
RECOMMENDED LAMP	1 X E27 7W LED 2700K	BACKPLATE DIMENSIONS	100MM DIAMETER
MAX WATTAGE (RETROFIT)	30W	NET PRODUCT WEIGHT	0.8KG
CE	YES	OVERALL HEIGHT WITH SHADE AS SHOWN	550MM
UKCA	YES	OVERALL HEIGHT WITHOUT SHADE	400MM
UL	YES	OVERALL WIDTH WITH SHADE AS SHOWN	180MM
DIMMABLE AS STANDARD?	YES	OVERALL WIDTH WITHOUT SHADE	100MM
DIMMING TYPE	PHASE		

### FOR MORE INFORMATION ABOUT THIS PRODUCT:

Email: [sales@chelsom.co.uk](mailto:sales@chelsom.co.uk) | Call: +44 (0)1253 831400

Chelsom Limited, Heritage House, Clifton Road, Blackpool, Lancashire FY4 4QA, United Kingdom

[wordpress-700079-2614039.cloudwaysapps.com](https://wordpress-700079-2614039.cloudwaysapps.com)

# — CHELSOM —

EST. 1947

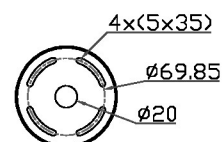
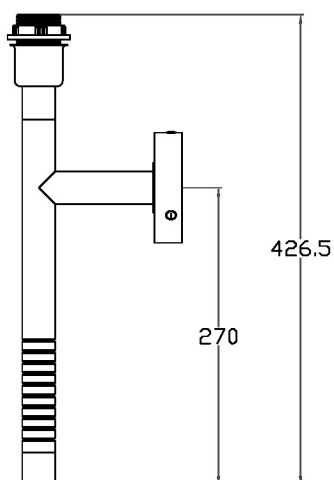
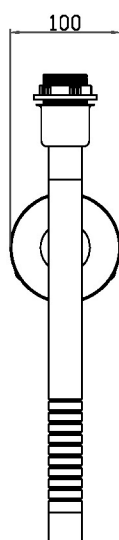
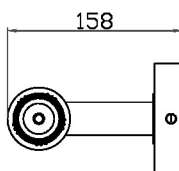
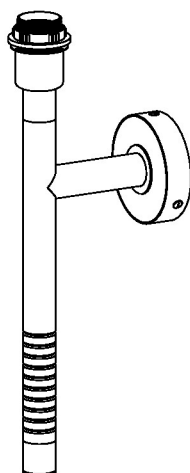

# — CHELSOM —

EST. 1947

FOLLOW THE NUMBERED ASSEMBLY SEQUENCE

