



#### FEATURES

AN UP-AND-OVER ARM CONFIGURATION SUSPENDS THE SHADE AT THE TOP AND RUNS DOWN ONTO BACKPLATE. TUBE ENDS HAVE A ROUNDED DETAIL AND FITTING IS COMPLETE WITH INTEGRAL OPAL ACRYLIC TOP DIFFUSER. SHADE IS BESPOKE WITH OTHER FABRIC OPTIONS AVAILABLE.

#### MATERIAL

STEEL AND ACRYLIC DIFFUSER

#### FINISH

BRUSHED BRASS (BRB) WITH OPAL ACRYLIC

#### RECOMMENDED LAMP

1 X E27 7W LED 2700K

#### CERTIFICATIONS

CE UK CA UL IP20

studio

#### DIMENSIONS

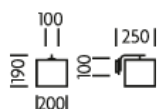

## FULL TECHNICAL SPECIFICATION

MATERIAL	STEEL AND ACRYLIC DIFFUSER	DIMMING TYPE	PHASE
FINISH	BRUSHED BRASS (BRB) WITH OPAL ACRYLIC	INSULATION RATING	CLASS I
LAMPHOLDER TYPE	E27	IP RATING	IP20
RECOMMENDED LAMP	1 X E27 7W LED 2700K	PROJECTION	250MM
MAX WATTAGE (RETROFIT)	30W	BACKPLATE DIMENSIONS	100MM DIAMETER
CE	YES	NET PRODUCT WEIGHT	0.55KG
UKCA	YES	OVERALL HEIGHT AS SHOWN	190MM
UL	YES	OVERALL WIDTH AS SHOWN	200MM
DIMMABLE AS STANDARD?	YES		

### FOR MORE INFORMATION ABOUT THIS PRODUCT:

Email: [sales@chelsom.co.uk](mailto:sales@chelsom.co.uk) | Call: +44 (0)1253 831400

Chelsom Limited, Heritage House, Clifton Road, Blackpool, Lancashire FY4 4QA, United Kingdom

[wordpress-700079-2614039.cloudwaysapps.com](https://wordpress-700079-2614039.cloudwaysapps.com)

# — CHELSOM —

EST. 1947

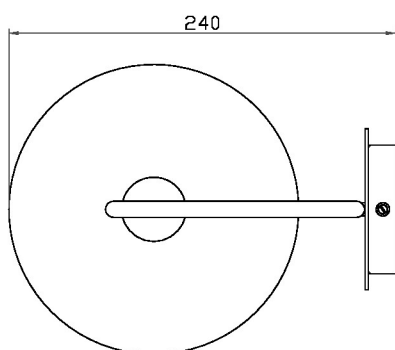
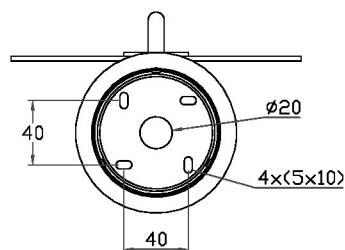
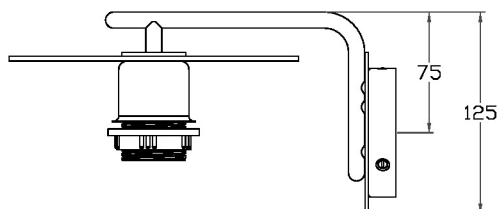
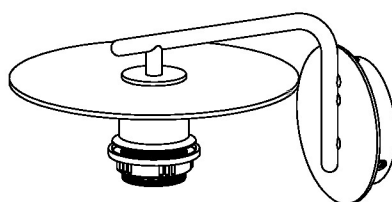

# — CHELSOM —

EST. 1947

FOLLOW THE NUMBERED ASSEMBLY SEQUENCE

