



FEATURES

HAS AN INTEGRAL DRIVER AND TWO SWITCHES, ONE FOR THE MAIN LIGHT AND ONE FOR THE LED READING LIGHT. DIFFERENT SWITCHING OPTIONS ARE AVAILABLE FOR MINIMUM QUANTITIES. SHADE IS BESPOKE AND HAS INTEGRAL TOP PARCHMENT DIFFUSER. OTHER FABRIC OPTIONS ARE AVAILABLE.

MATERIAL

STEEL

FINISH

CHAMPAGNE GOLD (CHG)

RECOMMENDED LAMP

1 X E27 7W LED 2700K PLUS 1 X LED 1W 2700K

CERTIFICATIONS

CE UK CA UL IP20

studio^c

DIMENSIONS

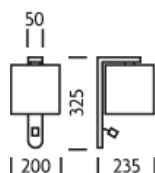

FULL TECHNICAL SPECIFICATION

MATERIAL	STEEL	DRIVER LOCATION	INTEGRAL
FINISH	CHAMPAGNE GOLD (CHG)	SWITCH TYPE	ROCKER
LAMPHOLDER TYPE	E27 AND INTEGRAL LED	DIMMABLE AS STANDARD?	BY REQUEST ONLY
RECOMMENDED LAMP	1 X E27 7W LED 2700K PLUS 1 X LED 1W 2700K	INSULATION RATING	CLASS I
COLOUR TEMPERATURE	2700K	IP RATING	IP20
MAX WATTAGE (RETROFIT)	30W	PROJECTION	235MM
WATTAGE (W) - INTEGRAL LED	1W	BACKPLATE DIMENSIONS	325 X 50MM
CE	YES	NET PRODUCT WEIGHT	2.5KG
UKCA	YES	OVERALL HEIGHT AS SHOWN	325MM
UL	YES	OVERALL WIDTH AS SHOWN	200MM

FOR MORE INFORMATION ABOUT THIS PRODUCT:

Email: sales@chelsom.co.uk | Call: +44 (0)1253 831400

Chelsom Limited, Heritage House, Clifton Road, Blackpool, Lancashire FY4 4QA, United Kingdom

wordpress-700079-2614039.cloudwaysapps.com

— CHELSOM —

EST. 1947

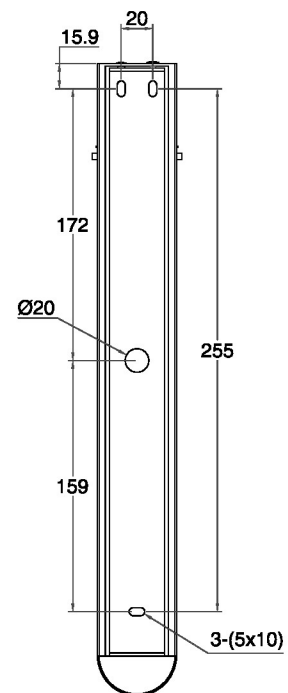
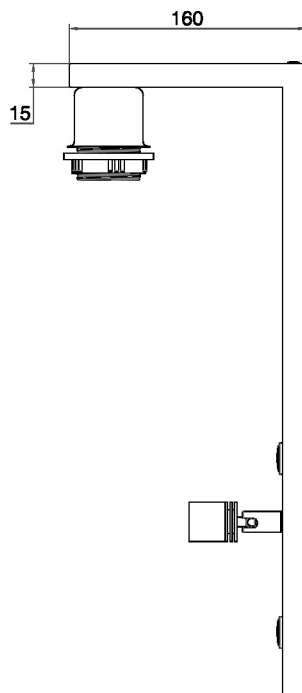
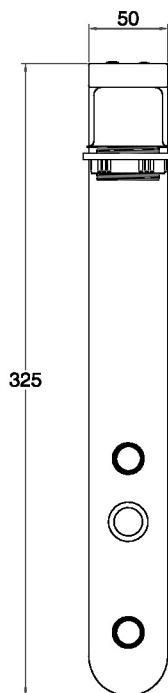
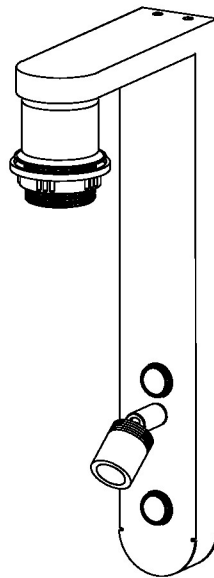

TR/4/W1/LED

Revision A

www.chelsom.co.uk

— CHELSOM —

EST. 1947

FOLLOW THE NUMBERED ASSEMBLY SEQUENCE

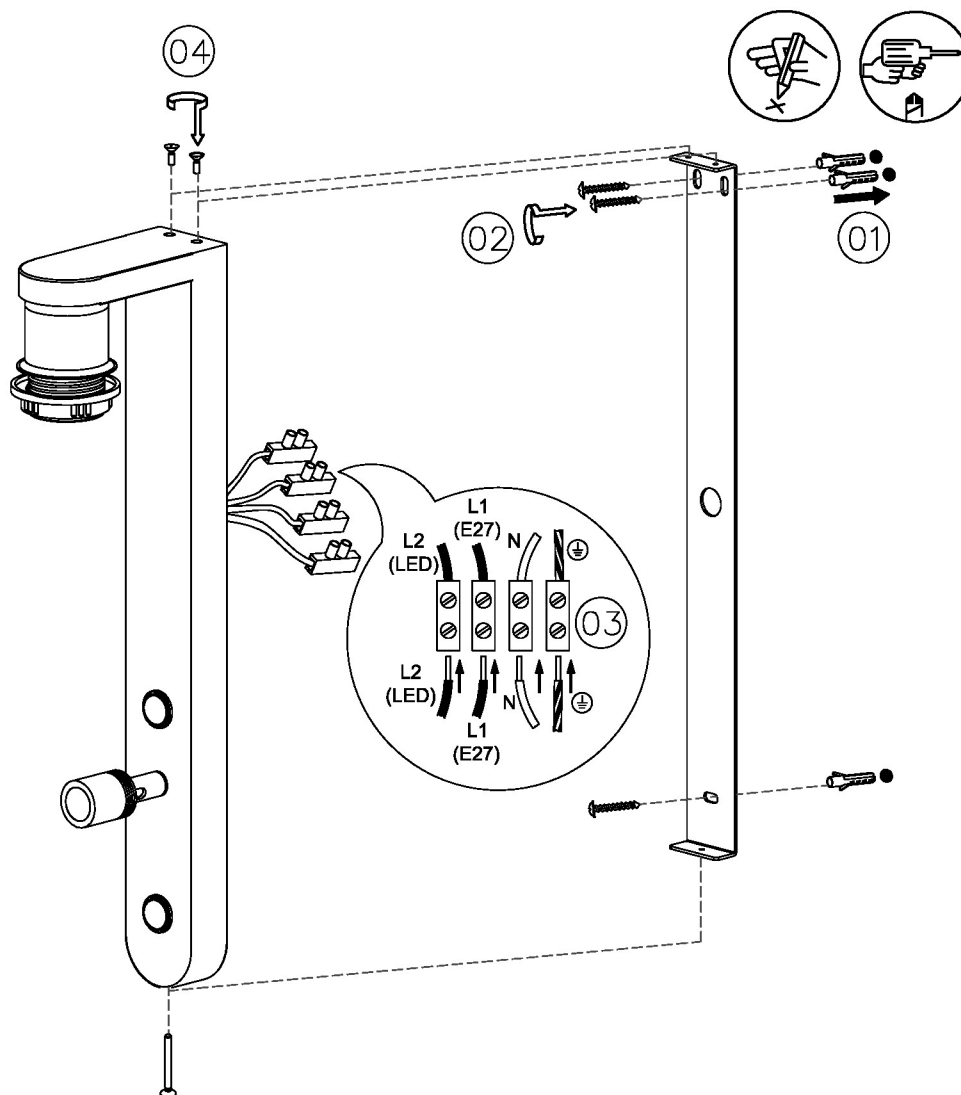

SLR Information

This product contains a light source
of Energy Efficiency Class E
Regulation 2021 No. 1095

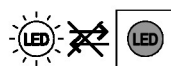

Non-replaceable
light source

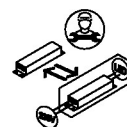

Control gear
replaceable by
qualified person

www.chelsom.co.uk