



FEATURES

DETAILED BACKPLATE AND SWAN NECK ARM WITH SWIVEL JOINT
SUPPORTS TUBULAR CANOPY WITH ANTI-GLARE BAFFLE ON THE
FRONT.

MATERIAL

STEEL

FINISH

ENGLISH BRASS (EBR)

RECOMMENDED LAMP

2 X E14 4W LED 2700K

CERTIFICATIONS

CE UKCA UL ± IP20

DIMENSIONS



FULL TECHNICAL SPECIFICATION

MATERIAL	STEEL	INSULATION RATING	CLASS I
FINISH	ENGLISH BRASS (EBR)	IP RATING	IP20
LAMPHOLDER TYPE	E14	WIDTH	550
RECOMMENDED LAMP	2 X E14 4W LED 2700K	HEIGHT	130
MAX WATTAGE (RETROFIT)	30W	PROJECTION	210MM
CE	YES	BACKPLATE DIMENSIONS	80MM DIAMETER
UKCA	YES	NET PRODUCT WEIGHT	1.4KG
UL	YES	OVERALL HEIGHT AS SHOWN	130MM
DIMMABLE AS STANDARD?	YES	OVERALL WIDTH AS SHOWN	550MM
DIMMING TYPE	PHASE		

FOR MORE INFORMATION ABOUT THIS PRODUCT:

Email: sales@chelsom.co.uk | Call: +44 (0)1253 831400

Chelsom Limited, Heritage House, Clifton Road, Blackpool, Lancashire FY4 4QA, United Kingdom
wordpress-700079-2614039.cloudwaysapps.com

— CHELSOM —

EST. 1947

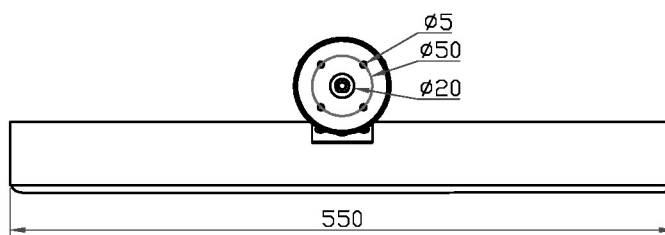
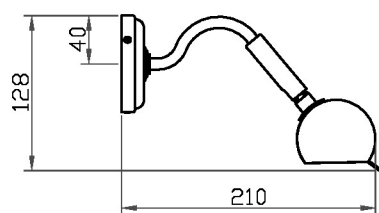
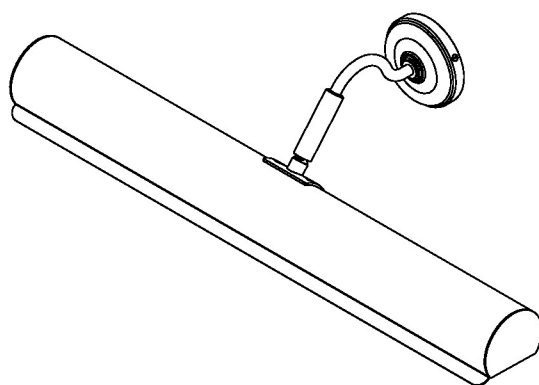

— CHELSOM —

EST. 1947

FOLLOW THE NUMBERED ASSEMBLY SEQUENCE

