



FEATURES

DIMMABLE INTEGRAL LED LIGHT SOURCE GIVES AMBIENT LIGHT THROUGH PERFORATED METAL FRAME WITH SOFT DIFFUSED DOWNLIGHT FROM OPAL ACRYLIC DIFFUSER.

MATERIAL

STEEL AND ACRYLIC

FINISH

GOLDEN BRONZE METALWORK WITH MATT OPAL ACRYLIC

CERTIFICATIONS

CE UK CA UL IP20

DIMENSIONS

300
Weight 1.85kg

FULL TECHNICAL SPECIFICATION

MATERIAL	STEEL AND ACRYLIC	DIMMABLE AS STANDARD?	YES
FINISH	GOLDEN BRONZE METALWORK WITH MATT OPAL ACRYLIC	DIMMING TYPE	1-10V
LAMPHOLDER TYPE	INTEGRAL LED	INSULATION RATING	CLASS I
INTEGRAL LIGHT SOURCE	LED 10W 2700K	IP RATING	IP20
COLOUR TEMPERATURE	2700K	WIDTH	300
WATTAGE (W) - INTEGRAL LED	10W	HEIGHT	100
CE	YES	CEILING PLATE DIMENSIONS	300MM DIAMETER
UKCA	YES	NET PRODUCT WEIGHT	1.85KG
UL	YES	OVERALL HEIGHT AS SHOWN	100MM
UL		OVERALL WIDTH AS SHOWN	300MM
DRIVER LOCATION	INTEGRAL		

FOR MORE INFORMATION ABOUT THIS PRODUCT:

Email: sales@chelsom.co.uk | Call: +44 (0)1253 831400

Chelsom Limited, Heritage House, Clifton Road, Blackpool, Lancashire FY4 4QA, United Kingdom

wordpress-700079-2614039.cloudwaysapps.com

— CHELSOM —

EST. 1947

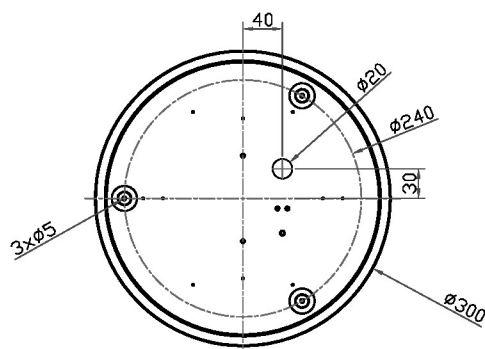
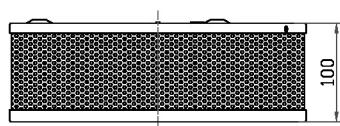
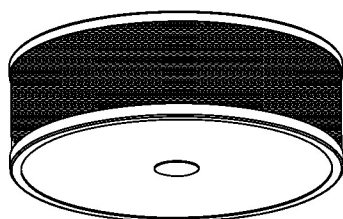

AD/35/FF

www.chelsom.co.uk

Revision A

— CHELSOM —

EST. 1947

FOLLOW THE NUMBERED ASSEMBLY SEQUENCE

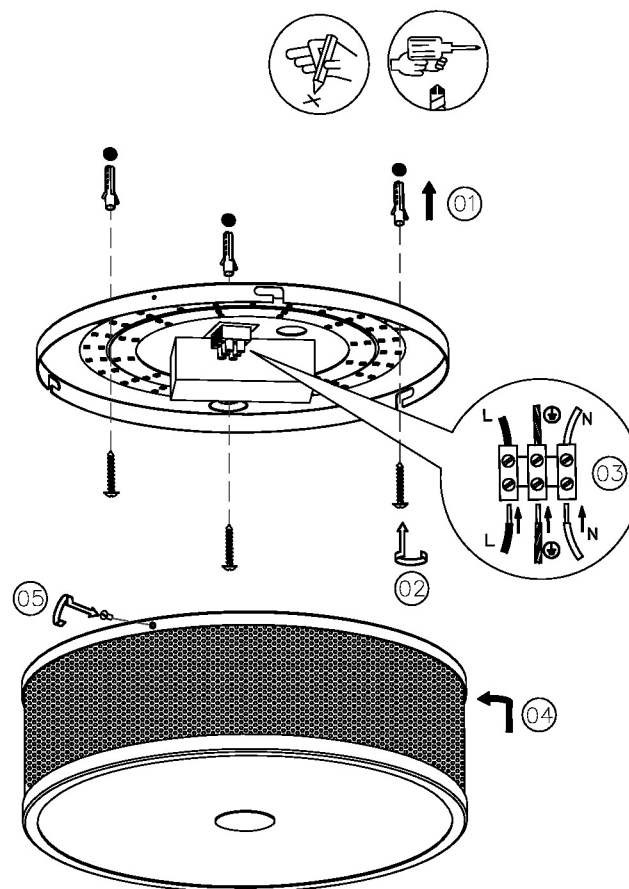

SLR Information

This product contains a light source
of Energy Efficiency Class E
Regulation 2021 No. 1095

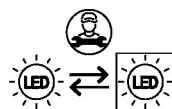

LED light source
replaceable by
qualified person

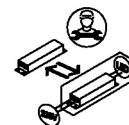

Control gear
replaceable by
qualified person

www.chelsom.co.uk