



FEATURES

ULTRA THIN METAL RING EMITS WARM LED LIGHT THROUGH OPAL ACRYLIC DIFFUSER. RING IS SUSPENDED ON ADJUSTABLE STRAINER WIRE WITH CONTROL GEAR HOUSED IN CEILING PLATE. THREE STANDARD SIZES (655MM; 855MM; AND 1155MM DIAMETER) ARE AVAILABLE AND CAN BE OFFERED IN VARIOUS CONFIGURATIONS. BESPOKE SHAPES, SIZES AND FINISHES CAN ALSO BE MANUFACTURED. PLEASE CONTACT OUR TEAMS TO DISCUSS FURTHER.

MATERIAL

STEEL AND ACRYLIC DIFFUSER

FINISH

SATIN BLACK WITH OPAL ACRYLIC DIFFUSER

CERTIFICATIONS

CE UK CA IP20

DIMENSIONS

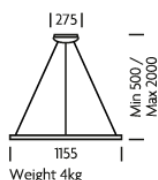

FULL TECHNICAL SPECIFICATION

MATERIAL	STEEL AND ACRYLIC DIFFUSER	DIMMABLE AS STANDARD?	YES
FINISH	SATIN BLACK WITH OPAL ACRYLIC DIFFUSER	DIMMING TYPE	PHASE
INTEGRAL LIGHT SOURCE	LED 29W 2700K	INSULATION RATING	CLASS I
COLOUR TEMPERATURE	2700K	IP RATING	IP20
WATTAGE (W) - INTEGRAL LED	29W	MINIMUM DROP	500MM
CE	YES	MAXIMUM DROP	CUSTOM
UKCA	YES	CEILING PLATE DIMENSIONS	275MM DIAMETER
UL	FOR UL PLEASE ENQUIRE.	NET PRODUCT WEIGHT	3.5KG
DRIVER LOCATION	INTEGRAL	OVERALL WIDTH WITH SHADE AS SHOWN	1155MM
SUSPENSION TYPE	WIRE		

FOR MORE INFORMATION ABOUT THIS PRODUCT:

Email: sales@chelsom.co.uk | Call: +44 (0)1253 831400

Chelsom Limited, Heritage House, Clifton Road, Blackpool, Lancashire FY4 4QA, United Kingdom

wordpress-700079-2614039.cloudwaysapps.com

— CHELSOM —

EST. 1947

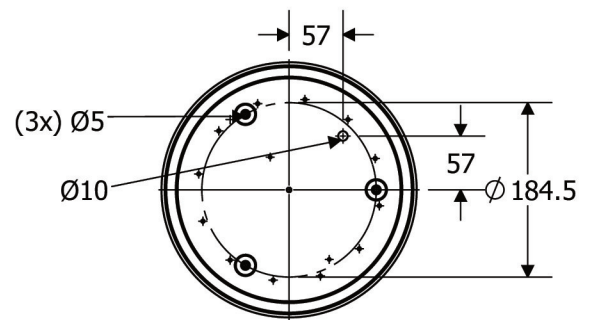
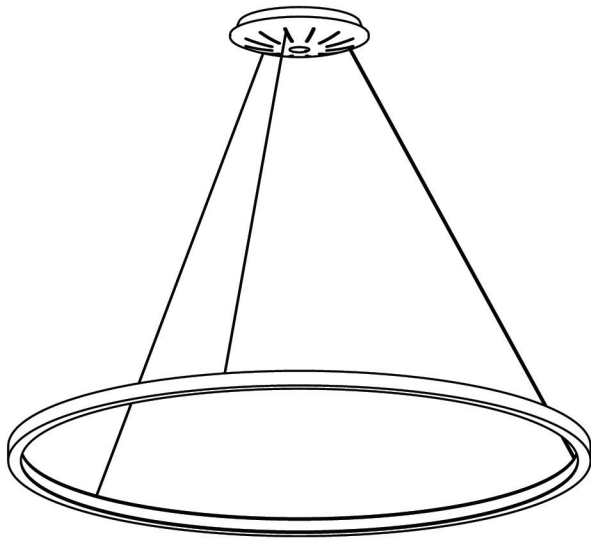

INTERNAL FIXING PLATE
VIEWED FROM BOTTOM

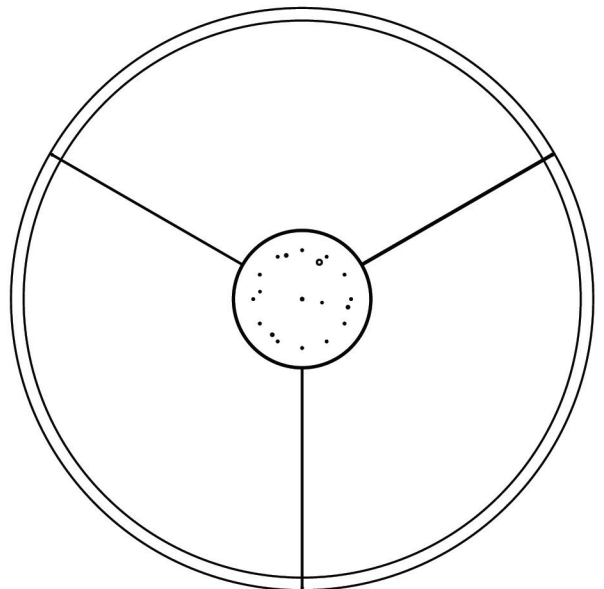
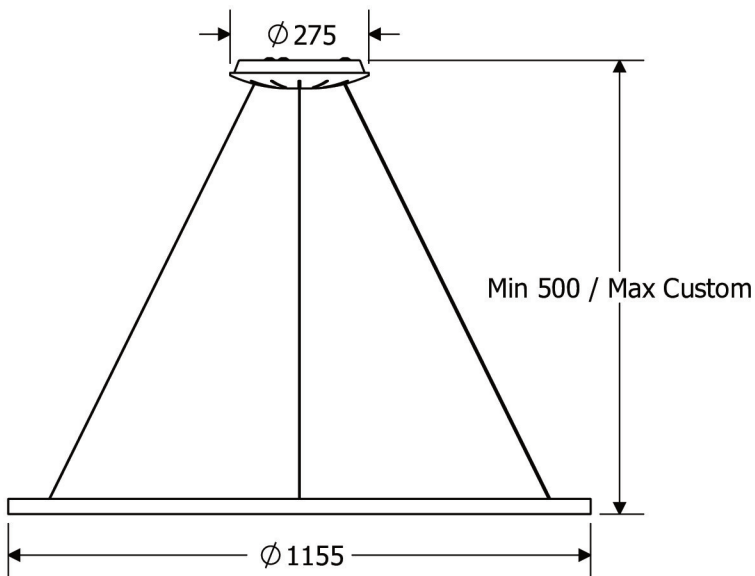

RS/10/1155

Revision A

www.chelsom.co.uk

— CHELSOM —

EST. 1947

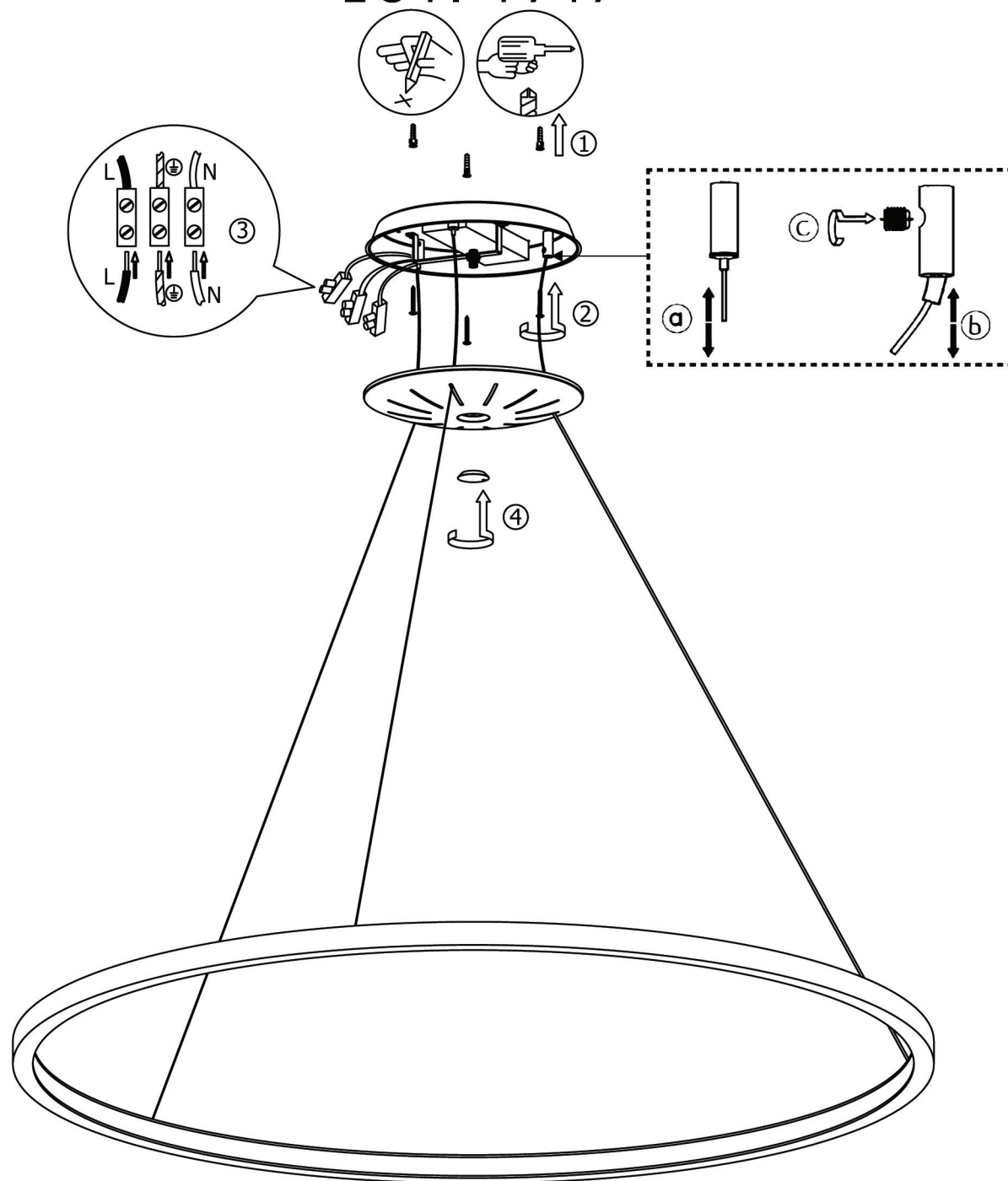

SLR Information

This product contains a light source
of Energy Efficiency Class E
Regulation 2021 No. 1095

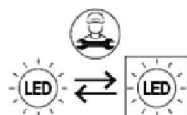

LED light source
replaceable by
qualified person

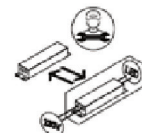

Control gear
replaceable by
qualified person

www.chelsom.co.uk