



FEATURES

A CURVED SCULPTURED WALL LIGHT WHICH EMITS A WARM GLOW OF UP AND DOWN LIGHT REFLECTED OFF THE CHAMPAGNE GOLD INTERIOR. IS PRICED WITH AND COMES COMPLETE WITH LAMPS AS SHOWN.

MATERIAL

STEEL

FINISH

SATIN BLACK WITH CHAMPAGNE GOLD (BL/CHG)

RECOMMENDED LAMP

2 X G9 2W LED 3000K

CERTIFICATIONS

CE UK CA UL IP20

DIMENSIONS

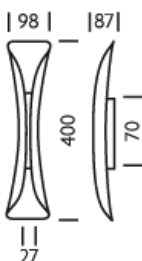

FULL TECHNICAL SPECIFICATION

MATERIAL	STEEL	DIMMABLE AS STANDARD?	BY REQUEST ONLY
FINISH	SATIN BLACK WITH CHAMPAGNE GOLD (BL/CHG)	INSULATION RATING	CLASS I
LAMPHOLDER TYPE	G9	IP RATING	IP20
RECOMMENDED LAMP	2 X G9 2W LED 3000K	PROJECTION	87MM
LAMP INCLUDED	YES	BACKPLATE DIMENSIONS	70 X 27MM
MAX WATTAGE (RETROFIT)	10W	NET PRODUCT WEIGHT	0.35KG
CE	YES	OVERALL HEIGHT AS SHOWN	400MM
UKCA	YES	OVERALL WIDTH AS SHOWN	98MM
UL	YES		

FOR MORE INFORMATION ABOUT THIS PRODUCT:

Email: sales@chelsom.co.uk | Call: +44 (0)1253 831400

Chelsom Limited, Heritage House, Clifton Road, Blackpool, Lancashire FY4 4QA, United Kingdom

wordpress-700079-2614039.cloudwaysapps.com

— CHELSOM —

EST. 1947

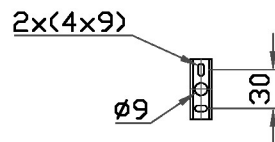
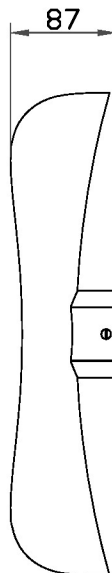
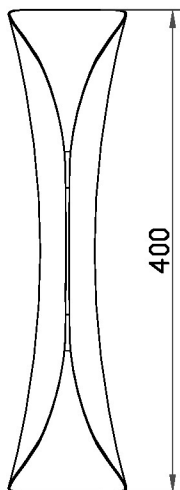
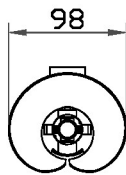
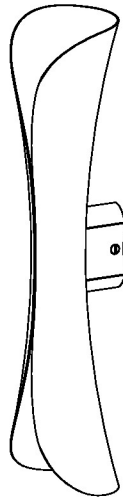

— CHELSOM —

EST. 1947

FOLLOW THE NUMBERED ASSEMBLY SEQUENCE

