



#### FEATURES

MATT OPAL GLASS GLOBE IS CENTERED WITHIN SHALLOW CONE WHICH REFLECTS THE WARM GLOW OF LIGHT. SUSPENDED WITH BLACK SILK COVERED CABLE. SUPPLIED FLAT-PACKED TO REDUCE PACKAGING VOLUME AND CARBON FOOTPRINT.

#### MATERIAL

STEEL AND GLASS

#### FINISH

BRUSHED BRASS WITH MATT OPAL GLASS

#### RECOMMENDED LAMP

1 X E14 4.5W LED 2700K

#### CERTIFICATIONS

CE UKCA UL  $\equiv$  IP20

#### DIMENSIONS



## FULL TECHNICAL SPECIFICATION

MATERIAL	STEEL AND GLASS	DIMMABLE AS STANDARD?	YES
FINISH	BRUSHED BRASS WITH MATT OPAL GLASS	DIMMING TYPE	PHASE
LAMPHOLDER TYPE	E14	INSULATION RATING	CLASS I
RECOMMENDED LAMP	1 X E14 4.5W LED 2700K	IP RATING	IP20
MAX WATTAGE (RETROFIT)	30W	MINIMUM DROP	275MM
CE	YES	MAXIMUM DROP	1215MM
UKCA	YES	CEILING PLATE DIMENSIONS	100MM DIAMETER
UL	YES	NET PRODUCT WEIGHT	2KG
SUSPENSION TYPE	BLACK SILK-COVERED CABLE	OVERALL WIDTH AS SHOWN	350MM

### FOR MORE INFORMATION ABOUT THIS PRODUCT:

Email: [sales@chelsom.co.uk](mailto:sales@chelsom.co.uk) | Call: +44 (0)1253 831400

Chelsom Limited, Heritage House, Clifton Road, Blackpool, Lancashire FY4 4QA, United Kingdom

[wordpress-700079-2614039.cloudwaysapps.com](https://wordpress-700079-2614039.cloudwaysapps.com)

# — CHELSOM —

EST. 1947

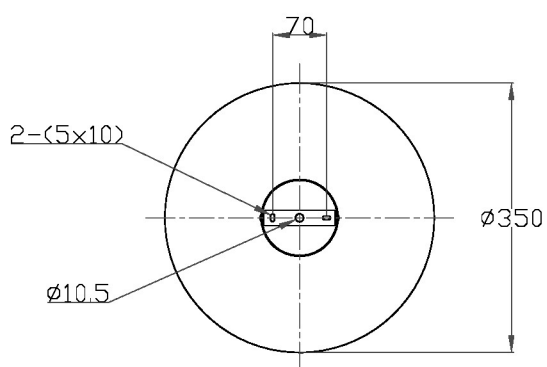
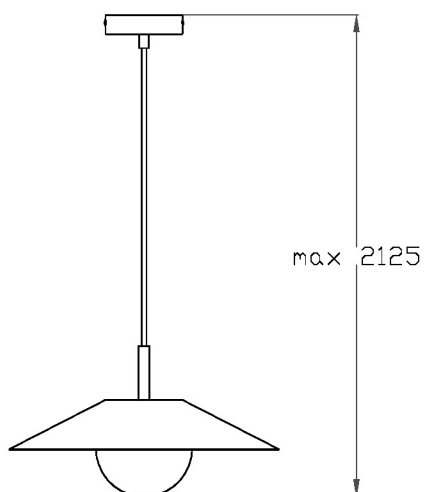
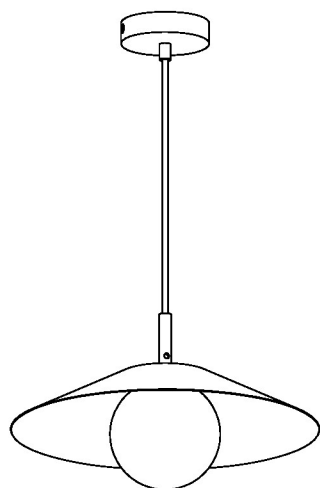

# — CHELSOM —

EST. 1947

FOLLOW THE NUMBERED ASSEMBLY SEQUENCE

