

FEATURES

THE PERFORATED METAL TAPERED HALF SHADE EMITS A WARM GLOW AND THROWS LIGHT ONTO THE OVAL BACKPLATE CREATING A HALO EFFECT AROUND ITS CONCAVE CURVED PERIMETER. 2200K FILAMENT LAMP RECOMMENDED.

MATERIAL

STEEL

FINISH

GOLDEN BRONZE WITH SATIN BLACK

RECOMMENDED LAMP

1 X E27 6W LED 2200K

CERTIFICATIONS

CE UK CA UL IP20

DIMENSIONS

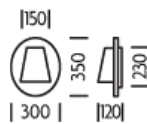

FULL TECHNICAL SPECIFICATION

MATERIAL	STEEL	DIMMING TYPE	PHASE
FINISH	GOLDEN BRONZE WITH SATIN BLACK	INSULATION RATING	CLASS I
LAMPHOLDER TYPE	E27	IP RATING	IP20
RECOMMENDED LAMP	1 X E27 6W LED 2200K	PROJECTION	120MM
MAX WATTAGE (RETROFIT)	30W	BACKPLATE DIMENSIONS	230 X 150MM
CE	YES	NET PRODUCT WEIGHT	2.2KG
UKCA	YES	OVERALL HEIGHT AS SHOWN	350MM
UL	YES	OVERALL WIDTH AS SHOWN	300MM
DIMMABLE AS STANDARD?	YES		

FOR MORE INFORMATION ABOUT THIS PRODUCT:

Email: sales@chelsom.co.uk | Call: +44 (0)1253 831400

Chelsom Limited, Heritage House, Clifton Road, Blackpool, Lancashire FY4 4QA, United Kingdom

wordpress-700079-2614039.cloudwaysapps.com

— CHELSOM —

EST. 1947

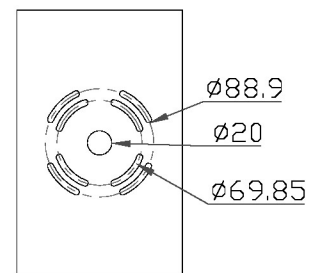
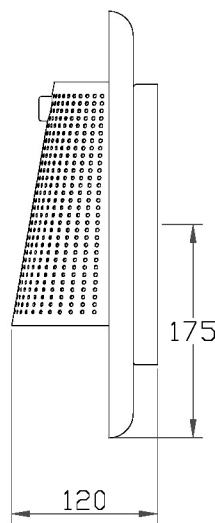
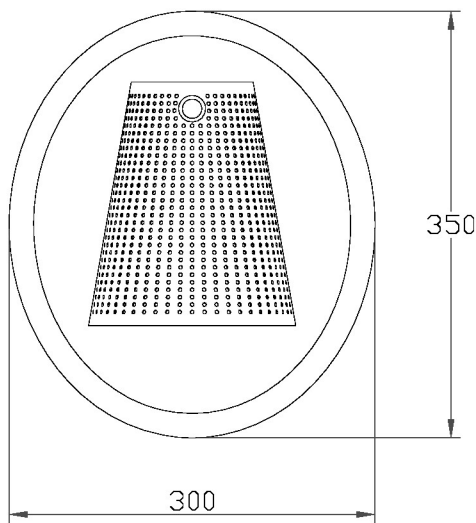
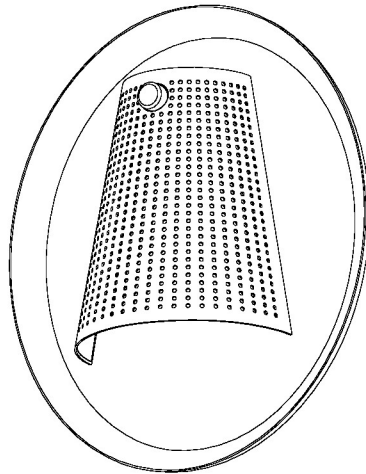

— CHELSOM —

EST. 1947

FOLLOW THE NUMBERED ASSEMBLY SEQUENCE

