



FEATURES

DEEPLY RIBBED ELLIPTICAL SHAPED MOUTHBLOWN VENETO GLASS GIVES A DRAMATIC LIGHT EFFECT. THE GOLD TOP REFLECTOR LAMP AVOIDS GLARE AND PRODUCES STRIKING PATTERN OF LIGHT ONTO WALLS. PRICED WITH AND COMES COMPLETE WITH LAMP AS SHOWN. ALSO SUITABLE FOR CEILING MOUNTING.

MATERIAL

STEEL AND GLASS

FINISH

BRUSHED BRASS METALWORK WITH SMOKE (SMOKE) GLASS

RECOMMENDED LAMP

1 X E27 6W LED 2700K

CERTIFICATIONS

CE UK CA UL IP20

DIMENSIONS

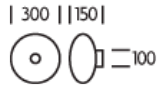

FULL TECHNICAL SPECIFICATION

MATERIAL	STEEL AND GLASS	DIMMABLE AS STANDARD?	YES
FINISH	BRUSHED BRASS METALWORK WITH SMOKE (SMOKE) GLASS	DIMMING TYPE	PHASE
LAMPHOLDER TYPE	E27	INSULATION RATING	CLASS I
RECOMMENDED LAMP	1 X E27 6W LED 2700K	IP RATING	IP20
LAMP INCLUDED	YES	PROJECTION	150MM
MAX WATTAGE (RETROFIT)	30W	BACKPLATE DIMENSIONS	100MM DIAMETER
CE	YES	NET PRODUCT WEIGHT	2KG
UKCA	YES	OVERALL HEIGHT AS SHOWN	300MM
UL	YES	OVERALL WIDTH AS SHOWN	300MM

FOR MORE INFORMATION ABOUT THIS PRODUCT:

Email: sales@chelsom.co.uk | Call: +44 (0)1253 831400

Chelsom Limited, Heritage House, Clifton Road, Blackpool, Lancashire FY4 4QA, United Kingdom

wordpress-700079-2614039.cloudwaysapps.com

— CHELSOM —

EST. 1947

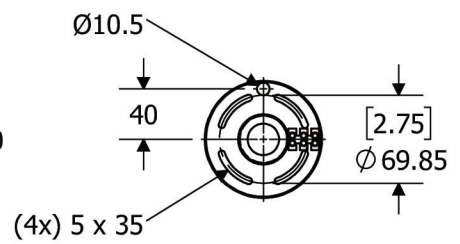
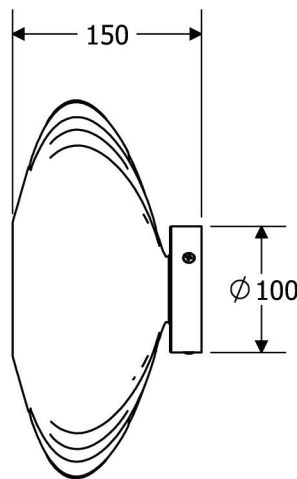
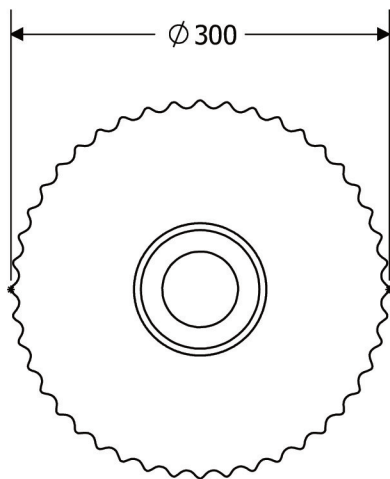
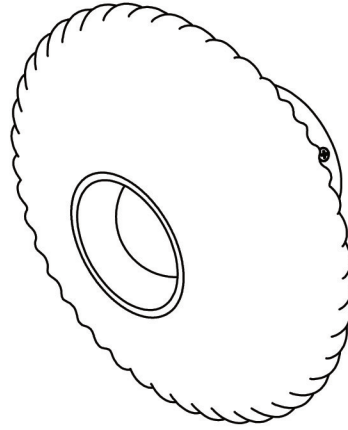

— CHELSOM —

EST. 1947

