



FEATURES

DIMMABLE INTEGRAL LED LIGHT SOURCES GIVE AMBIENT LIGHT THROUGH PERFORATED METAL FRAMES WITH SOFT DIFFUSED DOWNLIGHT FROM OPAL ACRYLIC DIFFUSERS.

MATERIAL

STEEL AND ACRYLIC

FINISH

GOLDEN BRONZE METALWORK WITH MATT OPAL ACRYLIC

CERTIFICATIONS

CE UK CA IP20

DIMENSIONS

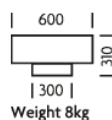

FULL TECHNICAL SPECIFICATION

MATERIAL	STEEL AND ACRYLIC	DIMMABLE AS STANDARD?	YES
FINISH	GOLDEN BRONZE METALWORK WITH MATT OPAL ACRYLIC	DIMMING TYPE	1-10V
LAMPHOLDER TYPE	INTEGRAL LED	INSULATION RATING	CLASS I
INTEGRAL LIGHT SOURCE	LED 20W 2700K	IP RATING	IP20
COLOUR TEMPERATURE	2700K	WIDTH	600
WATTAGE (W) - INTEGRAL LED	20W	HEIGHT	300
CE	YES	CEILING PLATE DIMENSIONS	600MM DIAMETER
UKCA	YES	NET PRODUCT WEIGHT	8KG
UL	FOR UL PLEASE ENQUIRE.	OVERALL HEIGHT AS SHOWN	310MM
DRIVER LOCATION	INTEGRAL	OVERALL WIDTH AS SHOWN	600MM

FOR MORE INFORMATION ABOUT THIS PRODUCT:

Email: sales@chelsom.co.uk | Call: +44 (0)1253 831400

Chelsom Limited, Heritage House, Clifton Road, Blackpool, Lancashire FY4 4QA, United Kingdom

wordpress-700079-2614039.cloudwaysapps.com

— CHELSOM —

EST. 1947

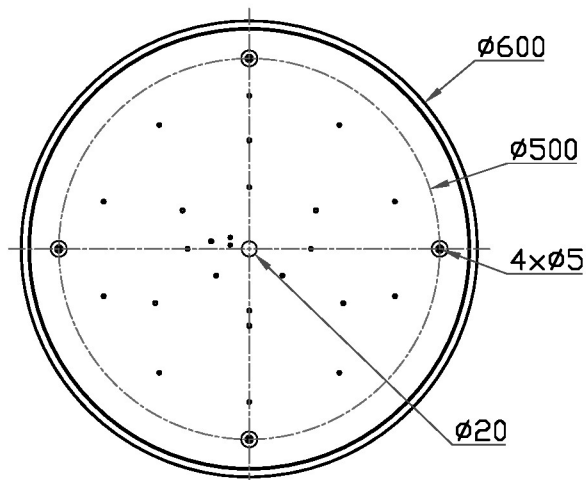
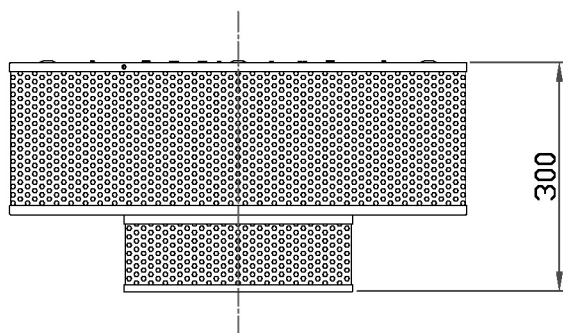
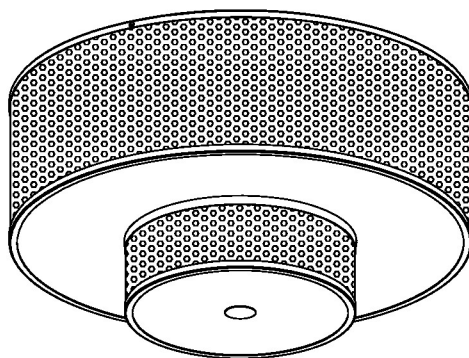

— CHELSOM —

EST. 1947

FOLLOW THE NUMBERED ASSEMBLY SEQUENCE

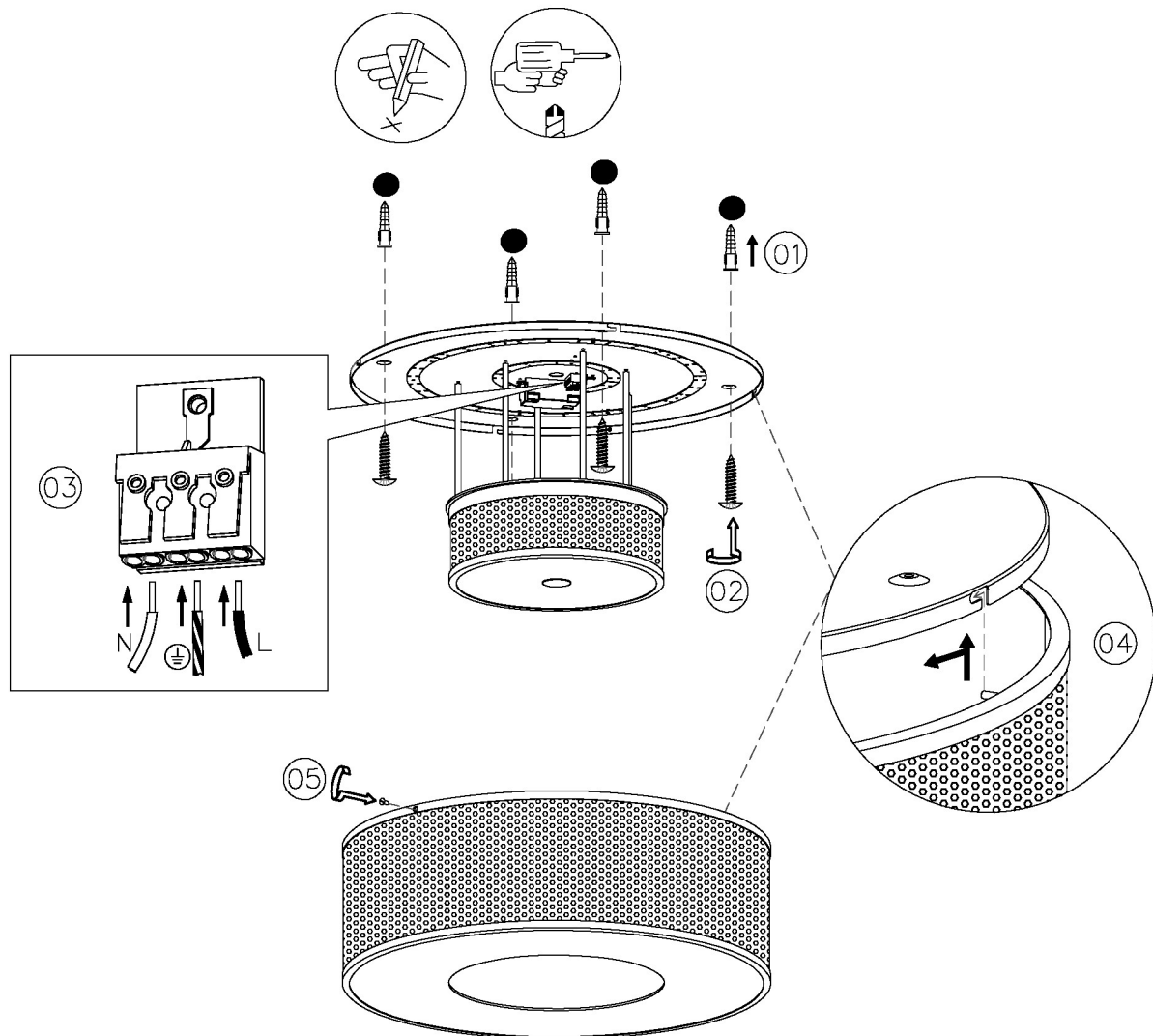

SLR Information

This product contains a light source of Energy Efficiency Class E Regulation 2021 No. 1095

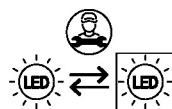

LED light source replaceable by qualified person

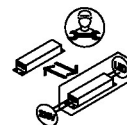

Control gear replaceable by qualified person

www.chelsom.co.uk