



#### FEATURES

HAS AN INTEGRAL DRIVER AND TWO SWITCHES, ONE FOR THE MAIN LIGHT AND ONE FOR THE LED READING LIGHT. DIFFERENT SWITCHING OPTIONS ARE AVAILABLE FOR MINIMUM QUANTITIES. SHADE IS BESPOKE AND HAS INTEGRAL TOP PARCHMENT DIFFUSER. OTHER FABRIC OPTIONS ARE AVAILABLE.

#### MATERIAL

STEEL

#### FINISH

CHAMPAGNE GOLD (CHG)

#### RECOMMENDED LAMP

1 X E27 7W LED 2700K PLUS 1 X LED 1W 2700K

#### CERTIFICATIONS

CE UK CA UL IP20

studio<sup>c</sup>

#### DIMENSIONS

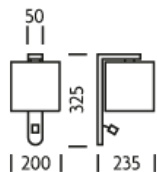

## FULL TECHNICAL SPECIFICATION

|                            |   |                         |                 |
|----------------------------|---|-------------------------|-----------------|
| MATERIAL                   | STEEL   | DRIVER LOCATION         | INTEGRAL        |
| FINISH                     | CHAMPAGNE GOLD (CHG)                          | SWITCH TYPE             | ROCKER          |
| LAMPHOLDER TYPE            | E27 AND INTEGRAL LED                          | DIMMABLE AS STANDARD?   | BY REQUEST ONLY |
| RECOMMENDED LAMP           | 1 X E27 7W LED 2700K<br>PLUS 1 X LED 1W 2700K | INSULATION RATING       | CLASS I         |
| COLOUR TEMPERATURE         | 2700K   | IP RATING               | IP20            |
| MAX WATTAGE (RETROFIT)     | 30W   | PROJECTION              | 235MM           |
| WATTAGE (W) - INTEGRAL LED | 1W  | BACKPLATE DIMENSIONS    | 325 X 50MM      |
| CE                         | YES   | NET PRODUCT WEIGHT      | 2.5KG           |
| UKCA                       | YES   | OVERALL HEIGHT AS SHOWN | 325MM           |
| UL                         | YES   | OVERALL WIDTH AS SHOWN  | 200MM           |

### FOR MORE INFORMATION ABOUT THIS PRODUCT:

Email: [sales@chelsom.co.uk](mailto:sales@chelsom.co.uk) | Call: +44 (0)1253 831400

Chelsom Limited, Heritage House, Clifton Road, Blackpool, Lancashire FY4 4QA, United Kingdom

[wordpress-700079-2614039.cloudwaysapps.com](https://wordpress-700079-2614039.cloudwaysapps.com)

# — CHELSOM —

EST. 1947

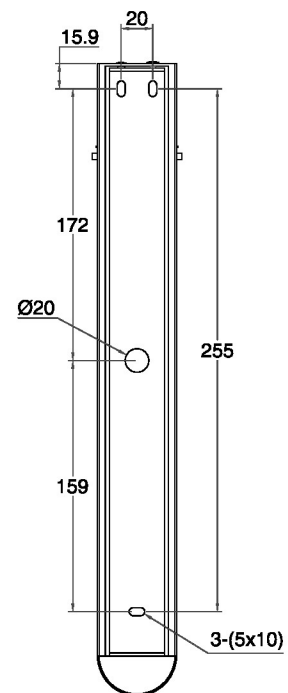
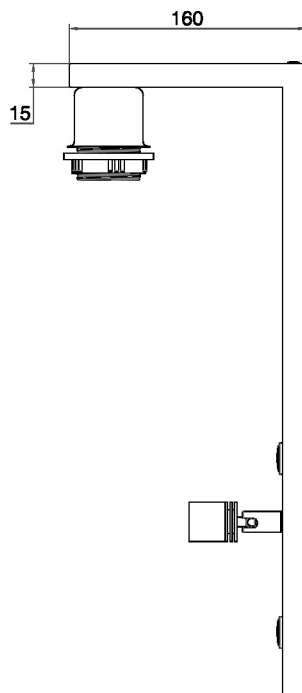
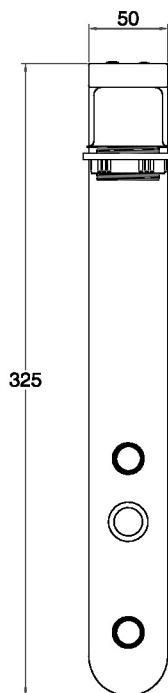
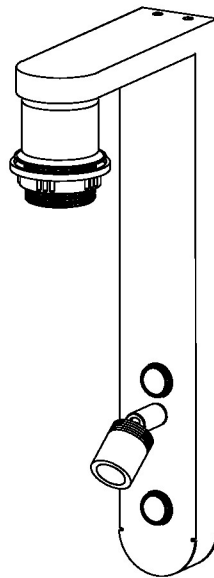

**TR/4/W1/LED**

**Revision A**

[www.chelsom.co.uk](http://www.chelsom.co.uk)

# — CHELSOM —

EST. 1947

FOLLOW THE NUMBERED ASSEMBLY SEQUENCE

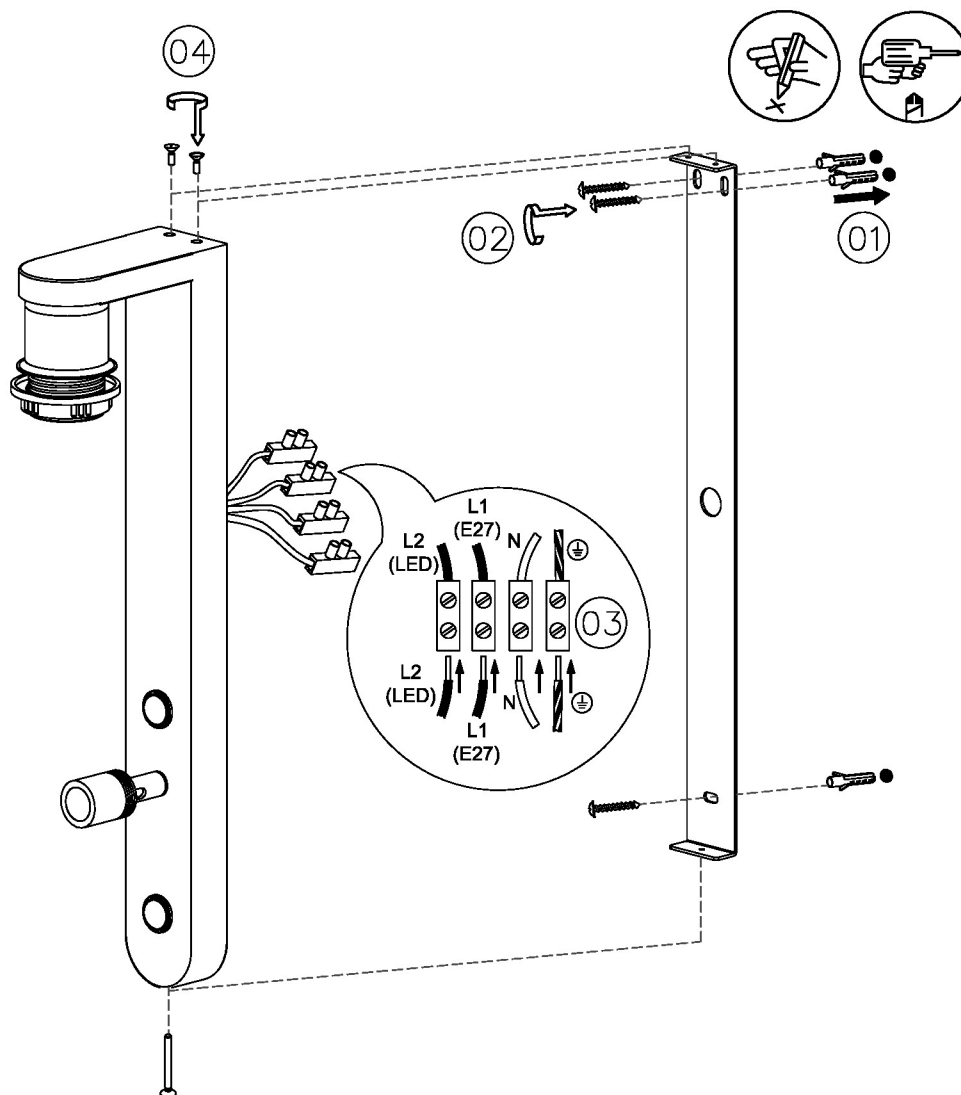

## SLR Information

This product contains a light source  
of Energy Efficiency Class E  
Regulation 2021 No. 1095

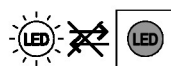

Non-replaceable  
light source

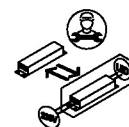

Control gear  
replaceable by  
qualified person

[www.chelsom.co.uk](http://www.chelsom.co.uk)