



FEATURES

HANDMADE FABRIC SHADE SITS WITHIN METAL CIRCLE
SUPPORTED BY COLUMN AND CIRCULAR BACKPLATE. SHADE IS
BESPOKE WITH OTHER FABRIC OPTIONS AVAILABLE.

MATERIAL

STEEL

FINISH

BRUSHED BRASS (BRB)

RECOMMENDED LAMP

1 X E27 7W LED 2700K

CERTIFICATIONS

CE UKCA UL ± IP20

DIMENSIONS

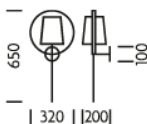

FULL TECHNICAL SPECIFICATION

MATERIAL	STEEL	DIMMING TYPE	PHASE
FINISH	BRUSHED BRASS (BRB)	INSULATION RATING	CLASS I
LAMPHOLDER TYPE	E27	IP RATING	IP20
RECOMMENDED LAMP	1 X E27 7W LED 2700K	PROJECTION	200MM
MAX WATTAGE (RETROFIT)	30W	BACKPLATE DIMENSIONS	100MM DIAMETER
CE	YES	NET PRODUCT WEIGHT	0.85KG
UKCA	YES	OVERALL HEIGHT AS SHOWN	650MM
UL	YES	OVERALL WIDTH AS SHOWN	320MM
DIMMABLE AS STANDARD?	YES		

FOR MORE INFORMATION ABOUT THIS PRODUCT:

Email: sales@chelsom.co.uk | Call: +44 (0)1253 831400

Chelsom Limited, Heritage House, Clifton Road, Blackpool, Lancashire FY4 4QA, United Kingdom
wordpress-700079-2614039.cloudwaysapps.com

— CHELSOM —

EST. 1947

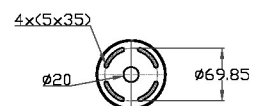
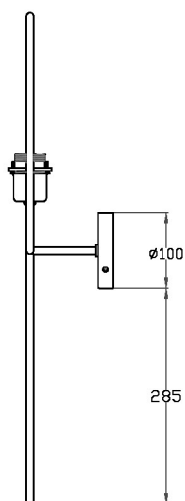
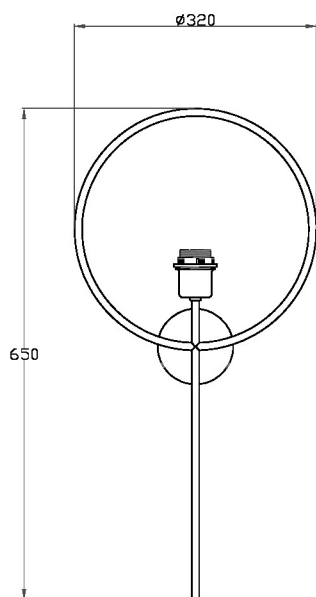
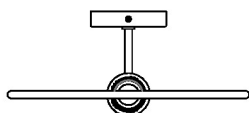
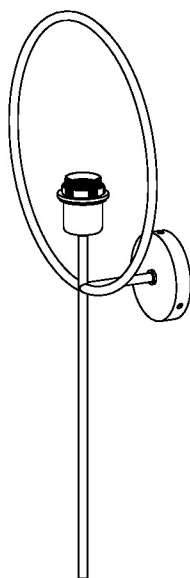

— CHELSOM —

EST. 1947

FOLLOW THE NUMBERED ASSEMBLY SEQUENCE

