

FEATURES

THIS WALL LIGHT FEATURES A FULLY ADJUSTABLE GLOSS BLACK METAL SHADE SECURED TO THE ARM WITH A DETAILED BRUSHED BRASS SWIVEL JOINT BRACKET. THERE IS A BRUSHED BRASS METAL PUSH SWITCH RECESSED INTO THE TOP OF THE SHADE WHICH HAS HEAT ESCAPE HOLES TO REFLECT THE RETRO STYLE.

MATERIAL

STEEL

FINISH

SATIN BLACK WITH GLOSS BLACK SHADE AND BRUSHED BRASS ACCENTS

RECOMMENDED LAMP

1 X E27 7W LED 2700K

CERTIFICATIONS

CE UKCA UL \equiv IP20

DIMENSIONS

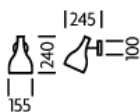

FULL TECHNICAL SPECIFICATION

MATERIAL	STEEL	DIMMABLE AS STANDARD?	BY REQUEST ONLY
FINISH	SATIN BLACK WITH GLOSS BLACK SHADE AND BRUSHED BRASS ACCENTS	INSULATION RATING	CLASS I
LAMPHOLDER TYPE	E27	IP RATING	IP20
RECOMMENDED LAMP	1 X E27 7W LED 2700K	PROJECTION	245MM
MAX WATTAGE (RETROFIT)	30W	BACKPLATE DIMENSIONS	100MM DIAMETER
CE	YES	NET PRODUCT WEIGHT	0.8KG
UKCA	YES	OVERALL HEIGHT AS SHOWN	240MM
UL	YES	OVERALL WIDTH AS SHOWN	155MM
SWITCH TYPE	PUSH		

FOR MORE INFORMATION ABOUT THIS PRODUCT:

Email: sales@chelsom.co.uk | Call: +44 (0)1253 831400

Chelsom Limited, Heritage House, Clifton Road, Blackpool, Lancashire FY4 4QA, United Kingdom

wordpress-700079-2614039.cloudwaysapps.com

— CHELSOM —

EST. 1947

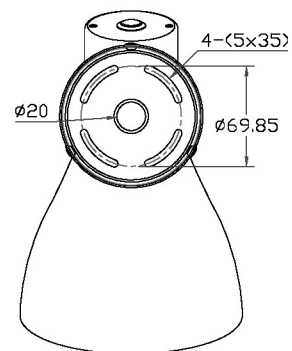
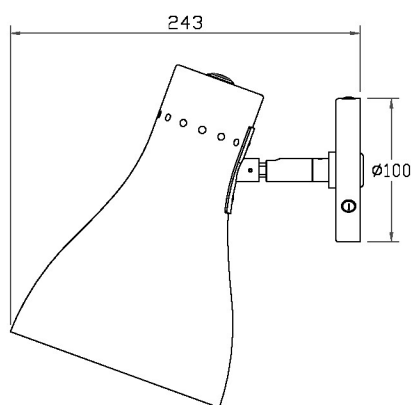
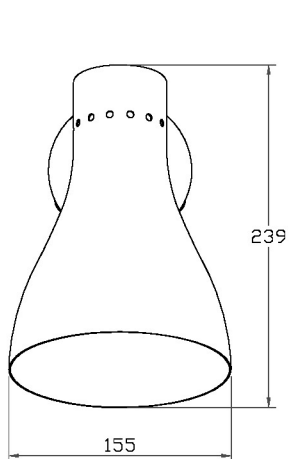
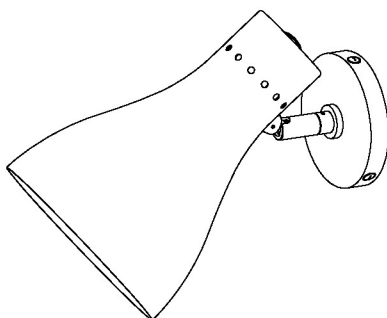

— CHELSOM —

EST. 1947

FOLLOW THE NUMBERED ASSEMBLY SEQUENCE

