



FEATURES

A WARM WHITE LED HEADBOARD READING LIGHT IS HOUSED WITHIN A RECTANGULAR HEAD THAT SWIVELS 90° LEFT, RIGHT OR FORWARD AND 'DOCKS' INTO A SEMI RECESSED BACKPLATE, WHICH CAN BE VERTICALLY OR HORIZONTALLY MOUNTED. HAS A COLOUR CO-ORDINATED METAL PUSH SWITCH ON THE BACKPLATE.

MATERIAL

STEEL AND ALUMINIUM

FINISH

BLACK BRONZE WITH ENGLISH BRASS (BB/EBR)

CERTIFICATIONS

CE UK CA UL IP20

DIMENSIONS

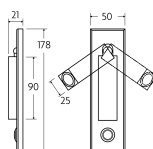

FULL TECHNICAL SPECIFICATION

MATERIAL	STEEL AND ALUMINIUM	DIMMABLE AS STANDARD?	BY REQUEST ONLY
FINISH	BLACK BRONZE WITH ENGLISH BRASS (BB/EBR)	INSULATION RATING	CLASS I
LAMPHOLDER TYPE	INTEGRAL LED	IP RATING	IP20
INTEGRAL LIGHT SOURCE	LED 1W 2700K	WIDTH	50
COLOUR TEMPERATURE	2700K	HEIGHT	178
WATTAGE (W) - INTEGRAL LED	1W	PROJECTION	108MM
CE	YES	BACKPLATE DIMENSIONS	178 X 50MM
UKCA	YES	CUTOUT DIMENSIONS	150 X 32MM
UL	YES	NET PRODUCT WEIGHT	0.35KG
DRIVER LOCATION	INTEGRAL	OVERALL HEIGHT AS SHOWN	178MM
SWITCH TYPE	PUSH	OVERALL WIDTH AS SHOWN	50MM

FOR MORE INFORMATION ABOUT THIS PRODUCT:

Email: sales@chelsom.co.uk | Call: +44 (0)1253 831400

Chelsom Limited, Heritage House, Clifton Road, Blackpool, Lancashire FY4 4QA, United Kingdom

wordpress-700079-2614039.cloudwaysapps.com

— CHELSOM —

EST. 1947

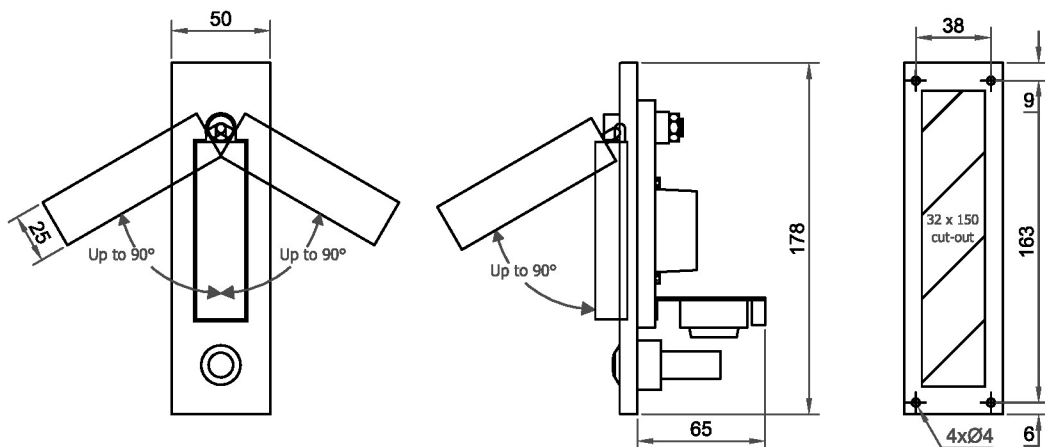
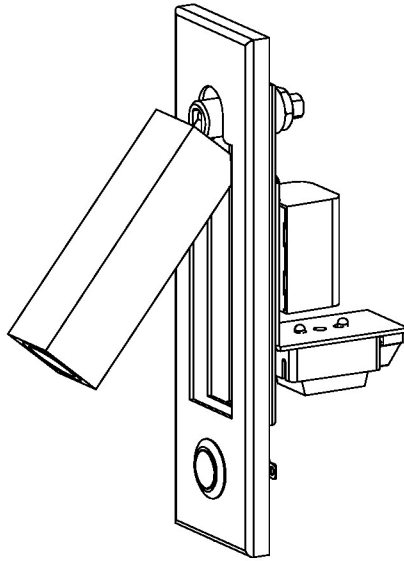

LED/5/1/SW

Revision A

www.chelsom.co.uk

— CHELSOM —

EST. 1947

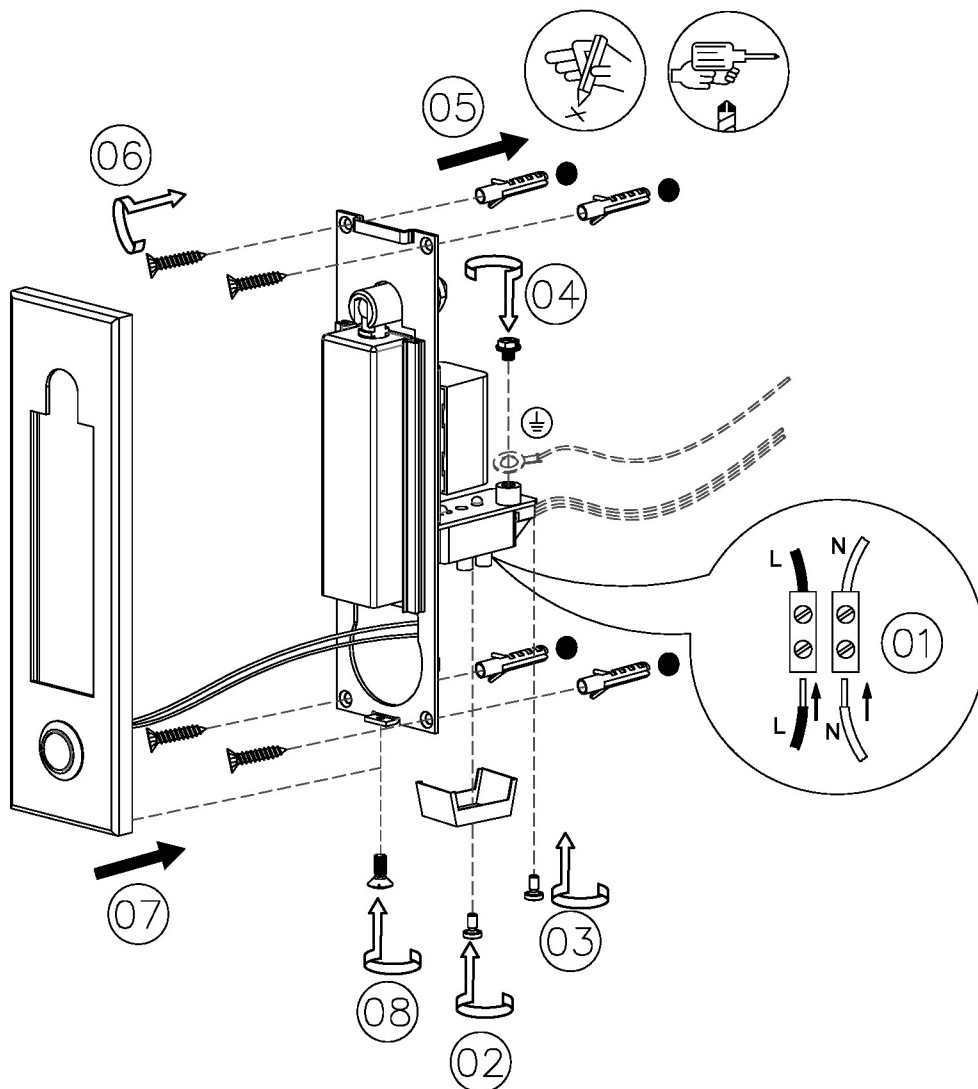

SLR Information

This product contains a light source
of Energy Efficiency Class E
Regulation 2021 No. 1095

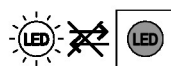

Non-replaceable
light source

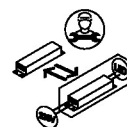

Control gear
replaceable by
qualified person

www.chelsom.co.uk